

HONSBERG - UR1 SERIES FLOW SWITCH

Paddle

UR1-010GM
Flow sw. 3-3.5 l/min.G3/8

- Switching range 1,3..35 l/min
- Water (oils, gases and aggressive media available on request)
- G $\frac{3}{8}$ " up to G2"
- Brass or stainless steel wetted parts
- Max pressure 25 bar



PRODUCT DESCRIPTION

The Honsberg UR1 is a simple flow switch which can easily be adjusted and also changed from normally open to normally closed. The flow switch works via a spring-supported paddle which moves according to the flow and when the specific flow is reached a magnetic reed switch is activated.

SPECIAL VERSIONS

- Plastic materials
- Weld/solder connection
- High volume OEM version
- Ex
- Switching ranges for oil or gas
- Special values
- High volume OEM version
- PVC (solder fitting)

SPECIFICATIONS

Contact Rating Max	50 A
Contact Rating Max	50 VA
Flow Max l/min Double	10 l/min
IP Class	IP65
Material breaker body	Hard ferrite
Material of body	Nickel-plated brass, Stainless steel 303
Material of connection	Nickel-plated brass
Material of seals	NBR
Materials Paddle	Stainless steel 301

Materials Wetted Parts	Nickel-plated brass, Stainless steel, Hard ferrite, NBR
Pressure Range Max	25 bar
Temperature range of media from	20 °C
Temperature range of media to	110 °C
Type of flow component	Flow Switches
Weight	0,35 kg
Viscosity	1 cSt
Voltage AC max	230 V

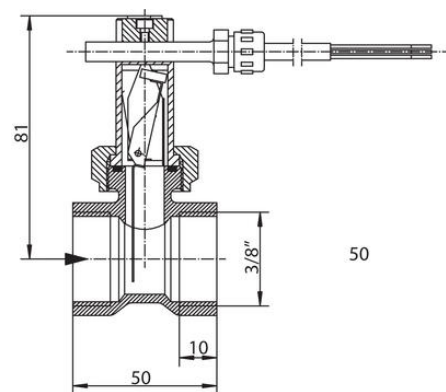

Adjustment

UR1 - loosen bolts, push the switching current tube into the desired position. Retighten the bolts.
Normally closed (n.c.) or normally open (n.o.) as per table "Technical data"

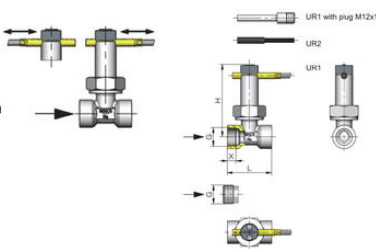

Dimensions and weights

G	Types	H	L	X	Weight kg
G 1/4	UR-010GM	82	50	10	UR1 0.35
	UR-010GK				UR2 0.40
	UR-015AM				0.35 0.30
G 1/2 A	UR-015AP	60	12		0.15 0.15
	UR-015GM				0.35 0.30
	UR-015GK				0.40 0.40
G 1/2	UR-020GM	83	12		0.35 0.35
	UR-020GK				
	UR-025GM				0.40 0.40
G 1	UR-025GM	87			0.45 0.45
	UR-025GK				
	UR-030GM				0.40 0.40
G 1 1/2	UR-030GM	91			0.50 0.50
	UR-030GK				
	UR-040GM				0.55 0.55
G 1 1/2	UR-040GM	94			0.65 0.65
	UR-040GK				
	UR-050GM				0.80 0.75
G 2	UR-050GM	103			0.95 0.95
	UR-050GK				